

NOTES:

1. MATERIAL:
  - 1.1 HOUSING: THERMOPLASTIC, HIGH TEMP, UL94V-0;
  - 1.2 CONTACT: COPPER ALLOY
  - 1.3 SHELL: COPPER ALLOY(NICKEL SLIVER)
2. FINISH:
  - CONTACT: 50~100u" NICKEL UNDERPLATING OVERALL.
  - 1: GOLD FLASH ON CONTACT AND SOLDER AREA
3. REFLOW SOLDER CAPABLE TO 260°C PER ACES SPEC.
4. SPEC. PLS. REFER TO SPEC-51306-XXXXX-XXX
5. PACKAGE PLS. REFER TO 50458-XXXXX-XX-TRP
6. PART NUMBER

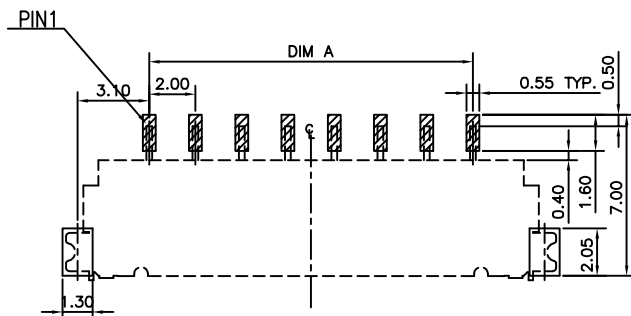
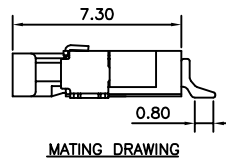
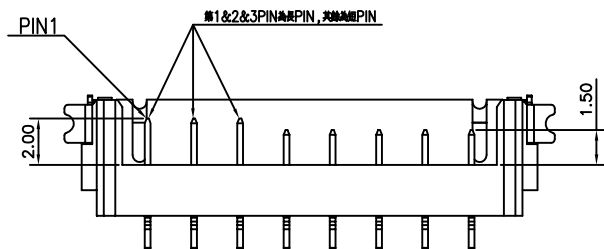
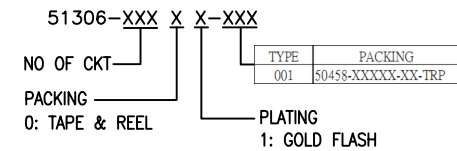
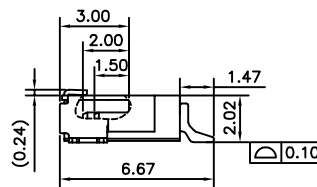
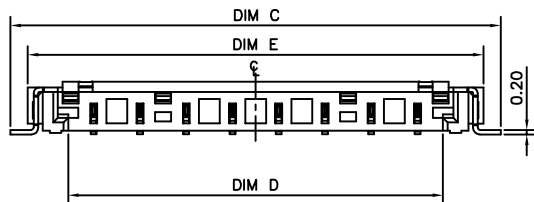

RECOMMENDED PCB LAYOUT  
GENERAL TOLERANCE ±0.05

CKTS	DIMA	DIMB	DIMC	DIMD	DIME
010	18	18.00	25.2	20.2	23.7
012	22	22.00	29.2	24.2	27.7

一般公差 <b>TOLERANCES</b> X ±0.5    XX ±0.15 X ±0.25    XXX ±0.1 ANGLES    ±2°		<b>宏致電子股份有限公司</b> <b>Aces Electronics Co.,Ltd.</b>	
檢驗尺寸標示 SYMBOLS (C) (D) INDICATE CLASSIFICATION DIMENSION (C) MARK IS CRITICAL DIM. (D) MARK IS MAJOR DIM.	品名 (TITLE) 2.0MM WTB WAFER CONN. SMT R/A TYPE 圖號 (DWG NO.) 51306-XXXXX-XXX	製圖 (DR) 20/05/19    LuTaoTao 審核 (CHKD) BRAVE 核准 (APPD) BRAVE	張數 (SHEET) 1 OF 1 單位 (UNITS) mm 比例 (SCALE) 1:1 表面處理 (FINISH)
		1 OF 1 A4 B	REV B